

## The First Test of English

**Text:**

Hi, my name is Susan. I am 13 years old. I am a pupil at Wilson School. My school is large and beautiful. It is in London. We have 12 classrooms, a sports ground, 2 physics labs, 2 biology labs, a computer room and a canteen where we have lunch. We have a lovely schoolyard where we play. We study 12 subjects there like: maths, English, Arabic, history, geography...etc. We start lessons at 8 o'clock in the morning and we finish at 4 o'clock in the afternoon. All pupils here are nice and polite.



**Part One: (14 pts)**

**A/ Reading Comprehension(07pts)**

**Activity one : Complete the table with information from the text (04pts).**

The school's name	City	Number of classrooms	Number of subjects
.....	.....	.....	.....

**Activity Two: Read the following statements and tick (✓) true or false (3pts)**

Statement	True	false
1- Susan's school has 1 physics lab.		
2- Pupils in Susan's school study 12 subjects.		
3- Lessons start at 4 o'clock in the afternoon.		

**B/ Mastery of language (7pts)**

**Activity One: Complete the following sentences with 'from', 'to' or 'on' (3pts).**

A: When do you study English?

B: I study English ..... Sunday, ..... 8: 00 a.m ..... 9:00 and ..... Thursday, ..... 3:00 p.m  
..... 4: 00 p.m.

**Activity Two: Check the correct box(✓)(2pts):**

- |                          |                          |                        |
|--------------------------|--------------------------|------------------------|
| I do                     | I don't                  |                        |
| <input type="checkbox"/> | <input type="checkbox"/> | chew gum in class.     |
| <input type="checkbox"/> | <input type="checkbox"/> | listen to the teacher. |
| <input type="checkbox"/> | <input type="checkbox"/> | eat food in class.     |
| <input type="checkbox"/> | <input type="checkbox"/> | respect my friends.    |

**Activity Three: Write the following words in the right box according to their vowel sound**

**pronunciation (2pts)**

I - speak- read- my

/ai/ h <u>i</u>	/i:/ gr <u>ee</u> n
.....	.....
.....	.....

**Part Two: Written Expression (6pts):**

A new pupil arrived at the school. He wants to know about the location of the following places: **the sports ground, the physics lab and the canteen.** Follow the map and write the dialogue between you and the new pupil.

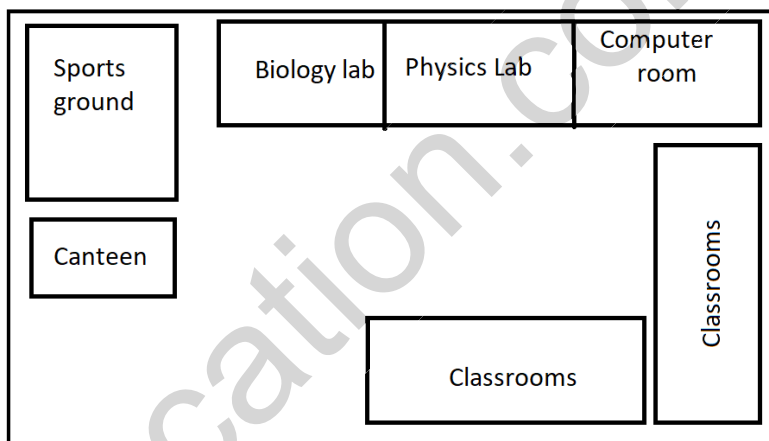

The new pupil: Excuse me, where is the sports ground?

You: .....

The new pupil: .....

You: .....

The new pupil: .....

You: .....

